

HYDROTECH



Hydrotech high pressure cleaning system  
*Drumfilter HDF*

Revised: 2020-08-07

# Table of content

<b>1. INTRODUCTION</b>	<b>3</b>
<b>2. OVERVIEW</b>	<b>4</b>
<b>3. FUNCTION</b>	<b>5</b>
<b>3.1 Intended area of use</b>	<b>5</b>
<b>3.2 Functional description</b>	<b>5</b>
<b>3.3 Nozzles</b>	<b>5</b>
<b>3.4 Pressure</b>	<b>5</b>
<b>3.5 Pump specifications</b>	<b>6</b>
<b>3.6 Maintenance</b>	<b>6</b>
<b>Symbols used on Hydrotech filters</b>	<b>7</b>
<b>Manuals &amp; technical information</b>	<b>8</b>

# 1. INTRODUCTION

This appendix is intended to describe Hydrotech's beltdriven high pressure washing system, for drumfilters of the HDF12/16/20 series.

PROPERTY OF DRAWINGS AND PRESCRIPTIONS  
All property rights and use remain to HYDROTECH AB Sweden  
General conditions and use for this drawing is in accordance to ORGALIME S2000

Ln.	Account name, number, etc.	Net value	Amount of
B	New motorbracket added.	2018-11-14	=

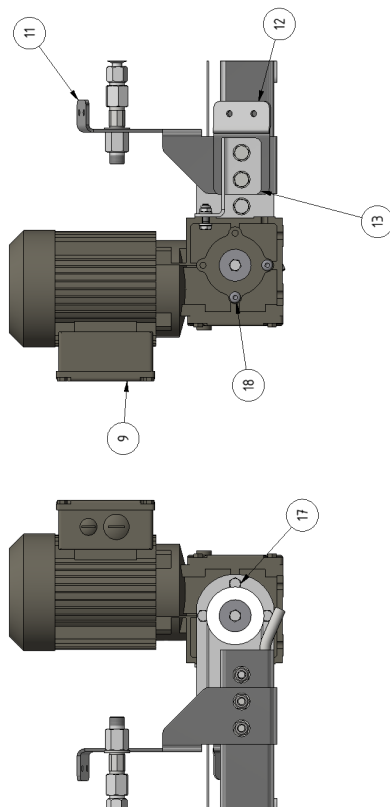

## 3. FUNCTION

### 3.1 Intended area of use

The equipment is designed to clean the filter's panels using pressurised water in order to remove long-term clogging.

### 3.2 Functional description

Hydrotech's high pressure cleaning system is an optional extra that is used independently of the filter's regular backwash system. The system comprises an arrangement with a sliding block, to which a spray arm with two nozzles is connected. This gradually moves along the entire filter. At each step the drum rotates one turn, while the nozzles spray the filter fabric with pressurised water to ensure that the entire filter area is cleaned.

The arrangement is connected to a pump that is supplied by an independent water source.

The quality of the water must be equivalent to tap water in terms of particles, to ensure that the pump and nozzles are not blocked.

Hydrotech's high pressure cleaning system can be used semi-automatically with the aid of a separate control box, or fully automated if the process is programmed in an automatic unit supplied with the filter.

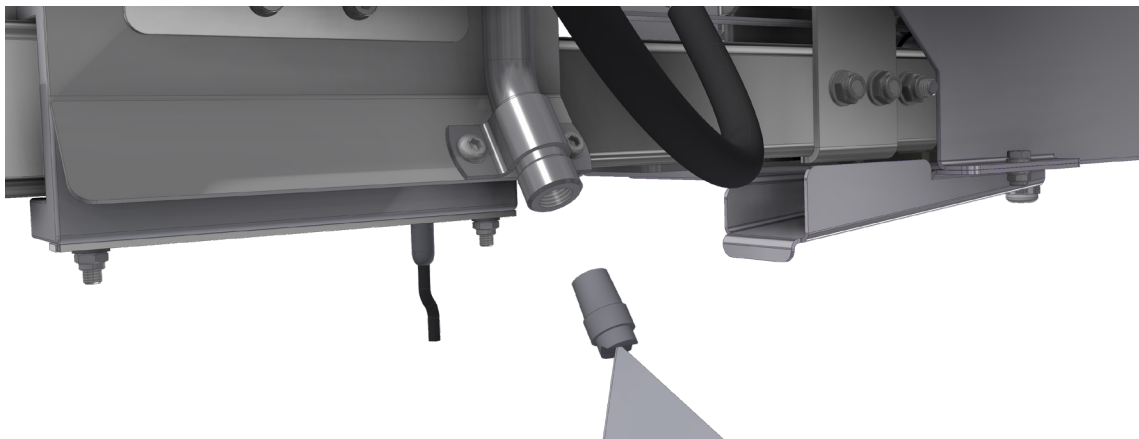

### 3.3 Nozzles

The high pressure cleaning system is designed for nozzles in size 6502. If one of the nozzles is not producing an even dispersion pattern, it needs to be cleaned or replaced.

### 3.4 Pressure

The recommended pressure is 80 bar. Higher pressures can damage the filter fabric.

## 3.5 Pump specifications

The pump must be adjustable and able to deliver 8.2 l/min at 80 bar.

## 3.6 Maintenance

Check the system for damaged parts at least every other week, depending on use.

Worn parts should be replaced as soon as possible. Contact your Hydrotech dealer.

Larger particles that disrupt the system's clearance can damage the system and must therefore be removed. Check at least every other week that there are no particles that can prevent the system from running freely.

The sensor must be kept clean. Check the sensor, and clean if necessary, at least every other week, depending on use.

## Symbols used on Hydrotech filters



Symbol is displaying equipotential earth bonding points on the filter.



Symbol shown at lubrication points on the filter. Read the manual for further information about lubrication.



Symbol displaying moving parts. Negligence to comply with safety regulations may lead to injury.



This symbol is placed where certain attention is needed when handling the filter. Read the manual for further information.



Warning for high voltage. Always assume all electrical equipment to be live and



Used as a warning where corrosive fluids is used. Always use appropriate safety equipment when handling corrosive products.

## Manuals & technical information

For further information regarding Hydrotech filters or any other product used together with Hydrotech filters, please visit [www.hydrotech.se](http://www.hydrotech.se). Click on "Manuals & technical information".

Locate the desired product manual and select manual by clicking on one of the language options. The manual will open in a new browser tab where the option to save the manual also can be found.



# HYDROTECH

**Hydrotech AB**  
**A Veolia Solutions & Technologies Company**  
Mejselgatan 6  
235 32 Vellinge  
Sweden

Telephone: +46 (0)40 - 42 95 30  
Fax: +46 (0)40 - 42 95 31  
E-mail: [mailbox@hydrotech.se](mailto:mailbox@hydrotech.se)  
Web: [www.hydrotech.se](http://www.hydrotech.se)  
Copyright © All rights reserved